

PUMP SPECIFICATIONS

PORT SIZE

- 1/4" BSP or 1/4" NPT female

MAX FREE FLOW ON WATER AT 20°C/68°F

- 18.1 LPM / 4.8 USGPM
(on some models 20% reduction should PTFE Diaphragms be fitted)

VOLUME DISPLACE PER FULL CYCLE

- 0.4 Litres / 0.01 US Gallons

MIN/MAX WORKING PRESSURE @ 20°C/68°F

- 1.4-6.9 Barg / 20-100 Psig

PUMP BODY MIN/MAX WORKING TEMP

- Polypropylene - 4-66°C / 40-150°F
- PVDF - 4-107°C / 40-225°F

MAX PUMPABLE PARTICLE SIZE

- 0.4mm / 1/64"

MAX DRY SUCTION LIFT ON WATER

- 2.5 metres / 7.5 feet

MAX WET SUCTION LIFT ON WATER

- 3.0 metres / 9 feet

MAX AIR CONSUMPTION

- 4.9 scfm / 8.3m³/hr

AIR INLET PORT SIZE

- 1/8" NPT female

MAX SOUND POWER LEVEL (DBA - ISO 9614-2)

- 76 dBA
(at max air inlet pressure - will reduce with air pressure)

BODY MATERIALS AVAILABLE AND WEIGHT

- Polypropylene - 1.49 kg / 3.3 lb
- PVDF - 1.49 kg / 3.3 lb

DIAPHRAGM & CHECK VALVE MATERIALS AVAILABLE

- Santoprene
- PTFE



PERFORMANCE CURVE

Pump tested in water with inlet submerged

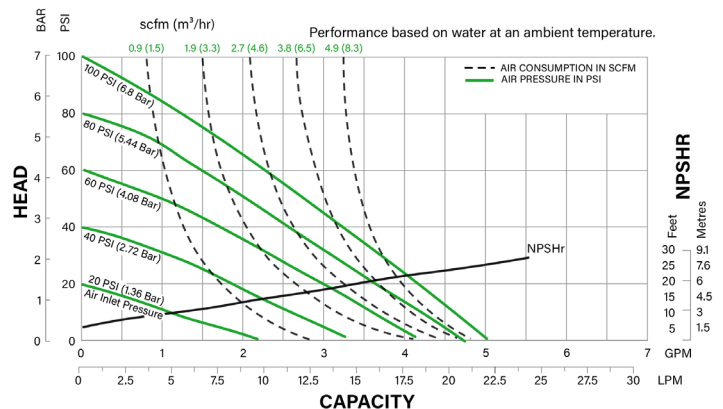

GA DRAWINGS

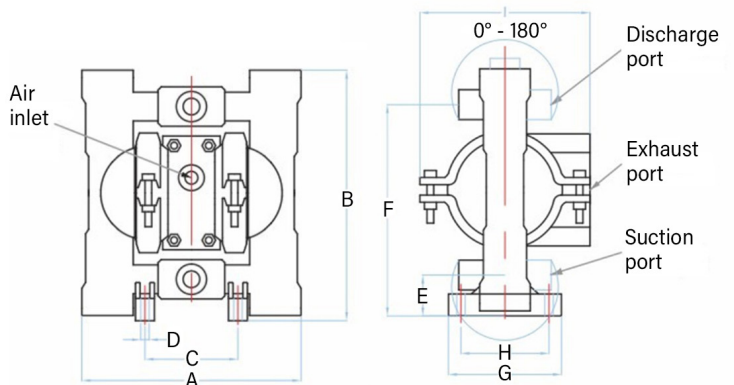

Port Size	Air Inlet Size	Exhaust Port Size	A	B	C	D	E	F	G	H	I
			mm	mm	mm	mm	mm	mm	mm	mm	mm
1/4" NPT	1/8" NPT	N/A	145	162	61	5	25	140	64	54	114
			5.7"	6.4"	2.4"	0.2"	1"	5.5"	2.5"	2.1"	4.5"