

### PUMP SPECIFICATIONS

#### PORT SIZE

- 2" Tri-Clamp

#### MAX FREE FLOW ON WATER AT 20°C/68°F

- 401 LPM / 106 USGPM

(on some models 20% reduction should PTFE Diaphragms be fitted)

#### VOLUME DISPLACE PER FULL CYCLE

- 3.1 Litres / 0.82 US Gallons

#### MIN/MAX WORKING PRESSURE @ 20°C/68°F

- 1.4-6.9 Barg / 20-100 Psig

#### PUMP BODY MIN/MAX WORKING TEMP

- 316 St Steel - 4-107°C / 40-225°F

#### MAX PUMPABLE PARTICLE SIZE

- 6.3mm / 1/4"

#### MAX DRY SUCTION LIFT ON WATER

- 4.6 metres / 14 feet (Rubber Balls)

#### MAX WET SUCTION LIFT ON WATER

- 7.6 metres / 23 feet (Rubber Balls)

#### MAX AIR CONSUMPTION

- 50 scfm / 85m<sup>3</sup>/hr

#### AIR INLET PORT SIZE

- 3/4" NPT female

#### AIR OUTLET PORT SIZE / MUFFLER

- 1" NPT female

#### MAX SOUND POWER LEVEL (DBA - ISO 9614-2)

- 100 dBA  
(at max air inlet pressure - will reduce with air pressure)

#### BODY MATERIALS AVAILABLE AND WEIGHT

- 316 St Steel - 42 kg / 93 lb

#### DIAPHRAGM & CHECK VALVE MATERIALS AVAILABLE

- Santoprene
- PTFE c/w Santoprene Backers
- PTFE



### PERFORMANCE CURVE

Pump tested in water with inlet submerged

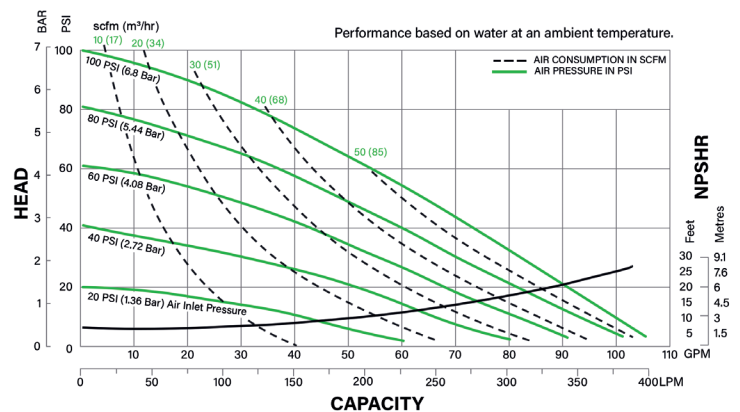

### GA DRAWINGS

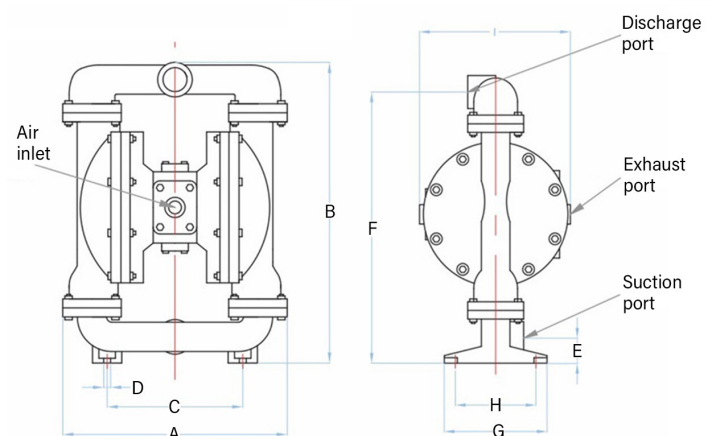

Port Size	Air Inlet Size	Exhaust Port Size	A	B	C	D	E	F	G	H	I	
			mm	mm	mm	mm	mm	mm	mm	mm	mm	standard muffler
2" Tri-Clamp	3/4" NPT	1" NPT	423 16.7"	559 22"	251 9.9"	13 0.5"	54 2.1"	526 20.7"	203 8"	178 7.0"	314 12.4"	368 14.5"



II 2GD c T5