

PUMP SPECIFICATIONS

PORT SIZE

- 3/4" Female & 1 1/2" Male BSP Dual Connection
- 3/4" Female & 1 1/2" Male NPT Dual Connection

MAX FREE FLOW ON WATER AT 20°C/68°F

- 90 LPM / 24 USGPM
- (on some models 20% reduction should PTFE Diaphragms be fitted)

VOLUME DISPLACEMENT PER FULL CYCLE

- 0.196 Litres / 0.052 US Gallons

VOLUME PER STROKE (HALF CYCLE)

- 0.098 Litres / 0.026 US Gallons

MAX WORKING PRESSURE @ 20°C/68°F

- 6.8 Barg / 100 Psig

PUMP BODY MIN/MAX WORKING TEMP

- Polypropylene - 4-66°C / 40-150°F
- PVDF - 0-93°C / 32-200°F

MAX PUMPABLE PARTICLE SIZE

- 4.1mm / 5/32" in diameter

MAX DRY SUCTION LIFT ON WATER

- 4.4 metres / 13 feet (Rubber Balls)

MAX WET SUCTION LIFT ON WATER

- 7.6 metres / 23 feet (Rubber Balls)

MAX AIR CONSUMPTION

- 20 scfm / 34m³/hr

AIR INLET PORT SIZE

- 1/4" NPT female

AIR OUTLET PORT SIZE / MUFFLER

- 3/8" NPT female

MAX SOUND POWER LEVEL (DBA - ISO 9614-2)

- 95 dBA
- (at max air inlet pressure - will reduce with air pressure)

BODY MATERIALS AVAILABLE AND WEIGHT

- Polypropylene - 6.2 kg
- PVDF - 8 kg

DIAPHRAGM & CHECK VALVE MATERIALS AVAILABLE

- Santoprene
- PTFE
- Hytrel
- Neoprene
- Nitrile
- FKM
- EPDM
- Stainless Steel

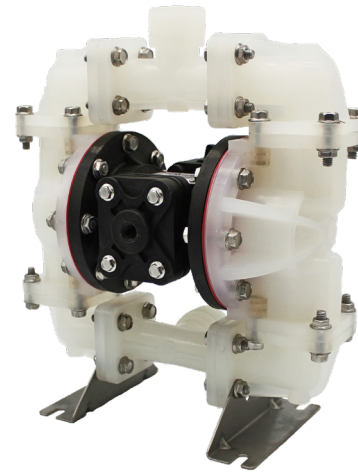

PERFORMANCE CURVE

Pump tested in water with inlet submerged

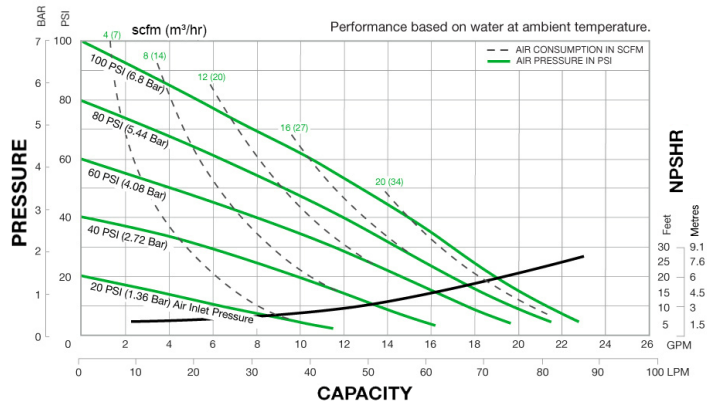

GA DRAWINGS

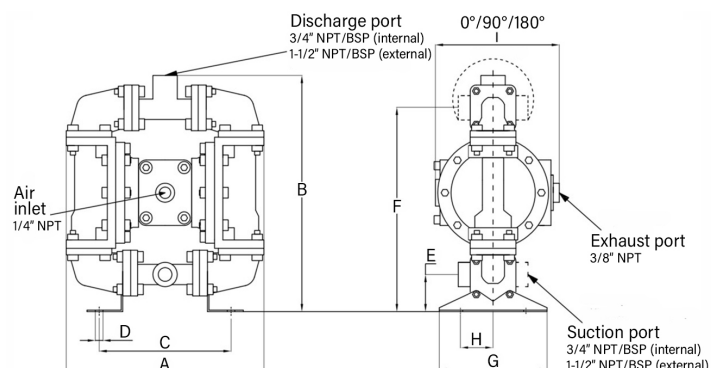

Port Size	Air Inlet Size	Exhaust Port Size	A	B	C	D	E	F	G	H	I	
			mm	mm	mm	mm	mm	mm	mm	mm	standard muffler (mm)	metal muffler (mm)
3/4" NPT/BSP (internal) 1 1/2" NPT/BSP (external)	1/4" NPT	3/8" NPT	300	357	184	9	64	297	143	57	179	222